

# Instruction Manual egg shell & egg dock ISOFIX base



ECE R129/03  
Rearward facing  
40-80cm/≤13kg



EN12790:  
2009

egg, BabyStyle UK Ltd, 36 Charles Street,  
Sileby, Leicestershire, LE12 7RJ  
United Kingdom  
Tel: 0044 1509 816444  
Fax: 0044 1509 816555,  
[info@eggstroller.com](mailto:info@eggstroller.com)  
[www.eggstroller.com](http://www.eggstroller.com)

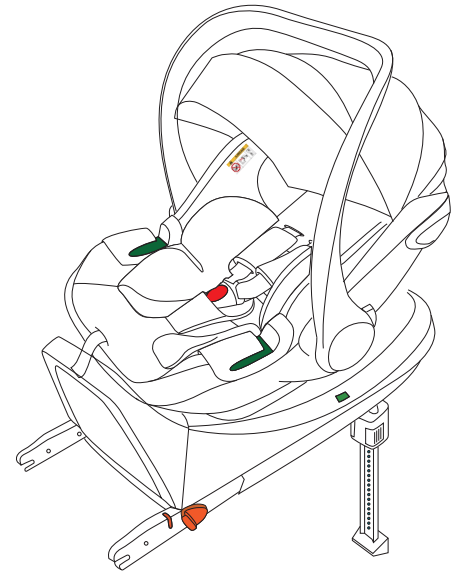

# 1

## CRS (Child Restraint System / Infant Carrier / Car Seat) Features

This type of product is referred to by several terms:  
CRS (Child Restraint System)  
Car seat  
Infant carrier

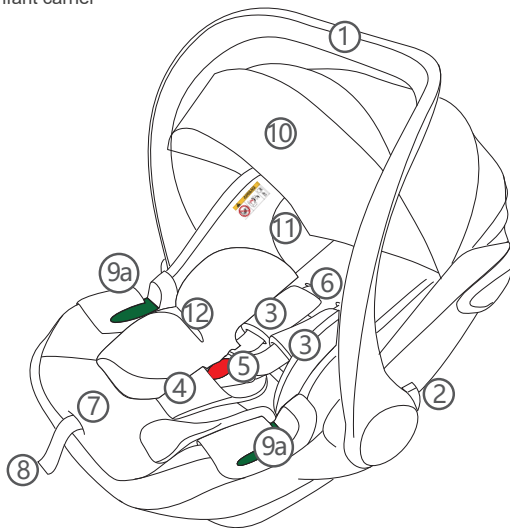

Instruction manual is located in compartment  
on back of infant carrier/car seat

(1)

# 2

View of seat back showing diagonal belt  
guide (green) and compartment for  
Instruction manual

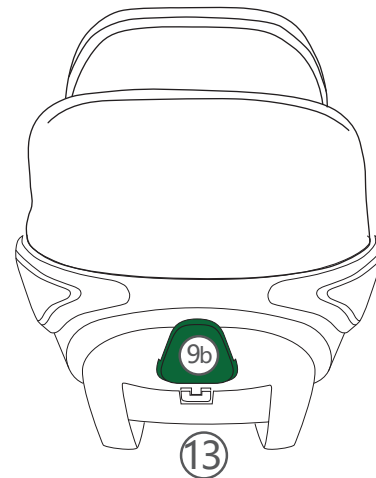

(2)

3 Carrying handle positions and harness adjustment

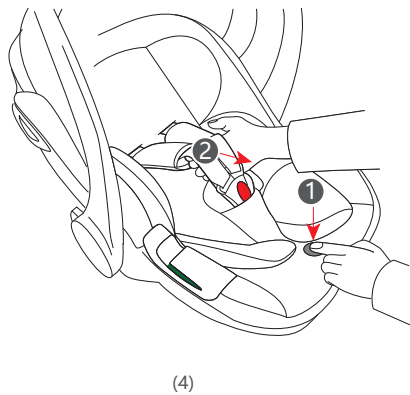
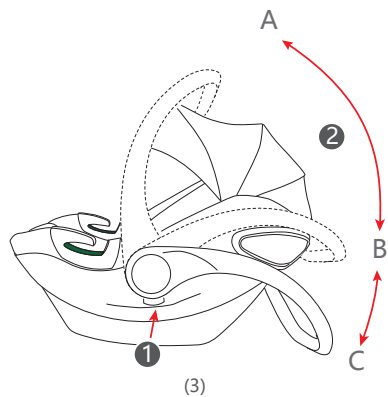

Open rear compartment to adjust harness shoulder straps height

4

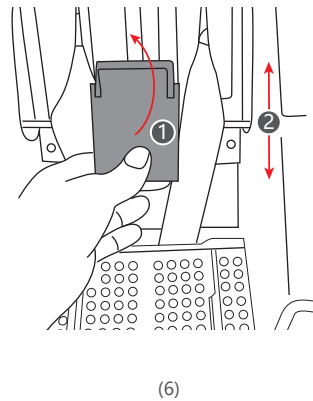
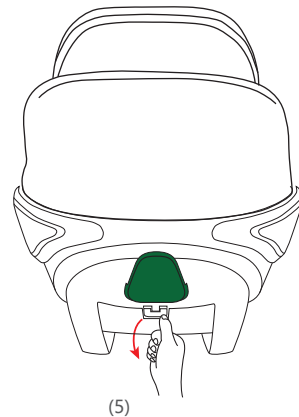

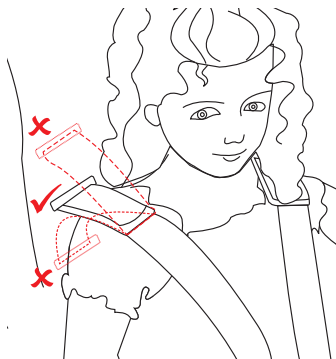

(7)

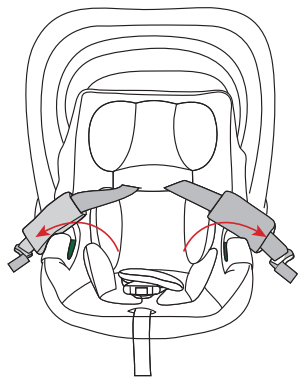

(8)

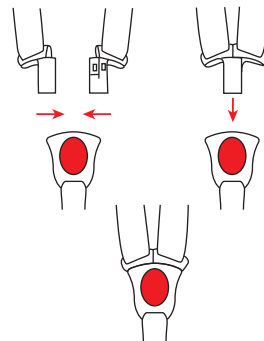

(9)

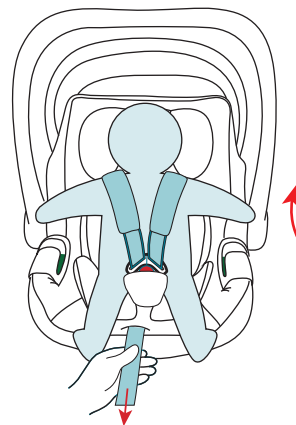

(10)

Baby height: 40-60cm

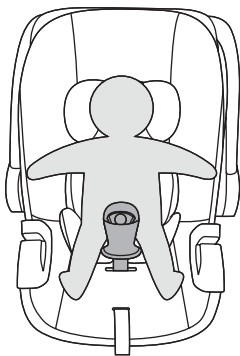

(9)

Baby height:  
greater than 60cm  
(remove lower cushion)

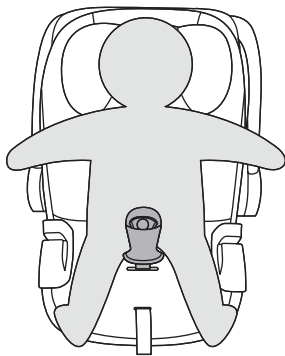

(12)

## Infant carrier installation with base

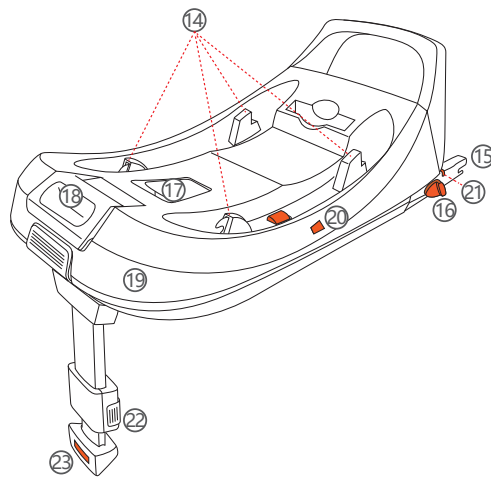

(13)

# Child Restraint System fitted to ISOFIX base

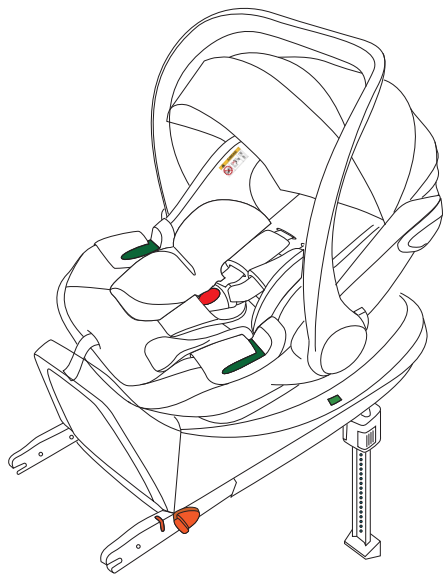

(14)

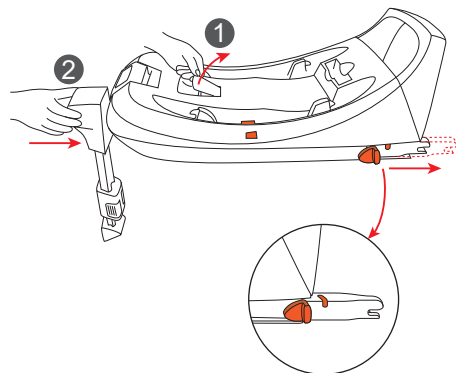

(15)

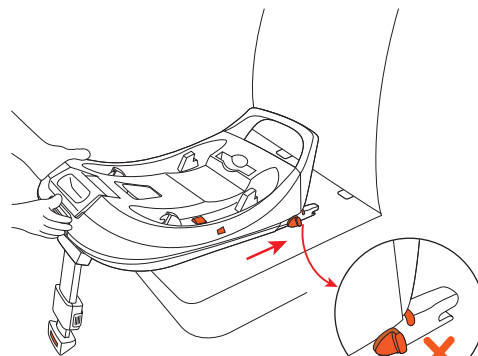

(16)

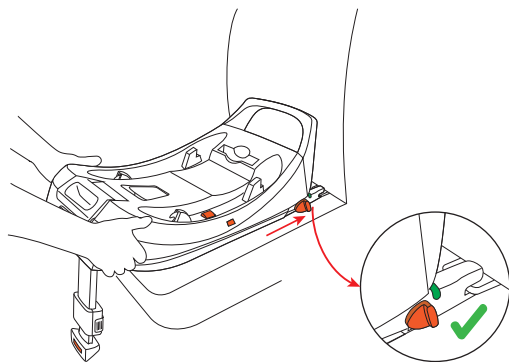

(17)

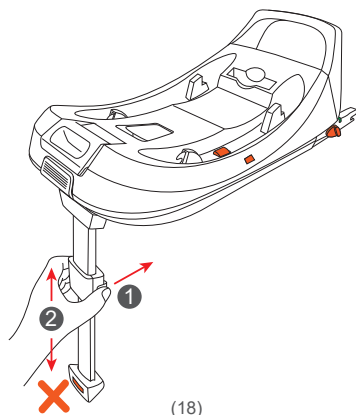

(18)

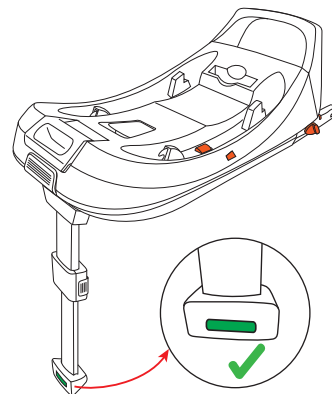

(19)

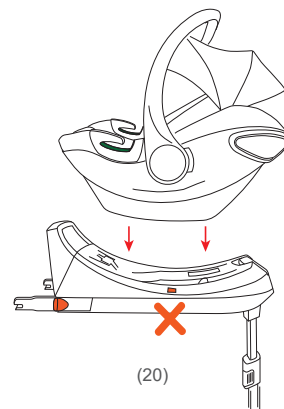

(20)

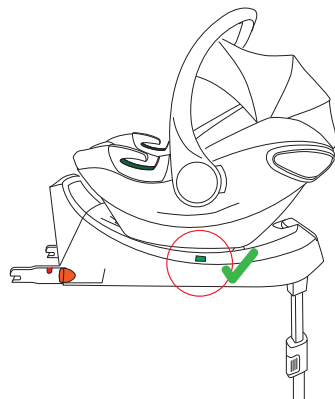

(21)

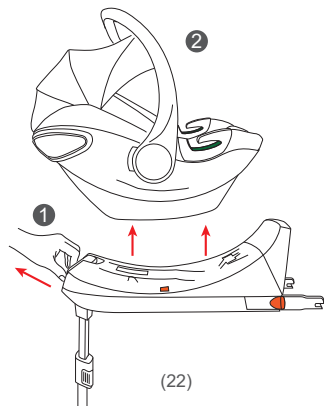

(22)

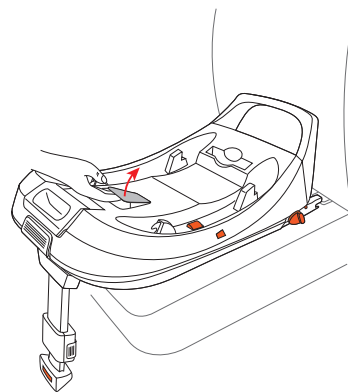

(23)

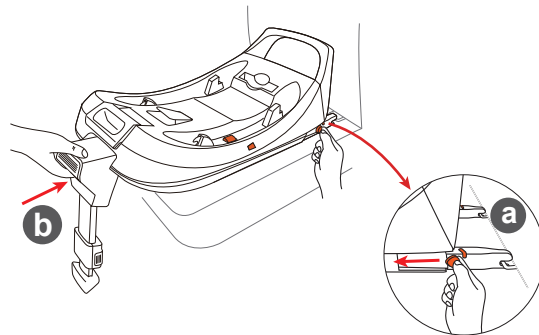

(24)



Infant carrier belted installation.  
Only suitable with adult three-point belt

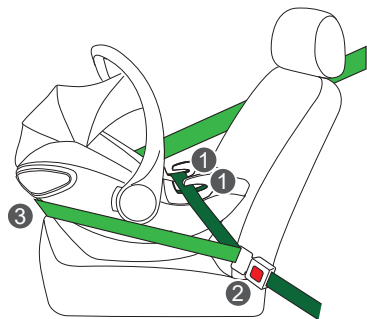

(25)

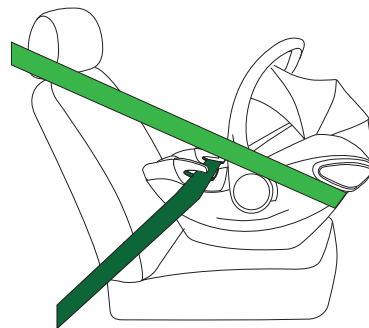

(26)

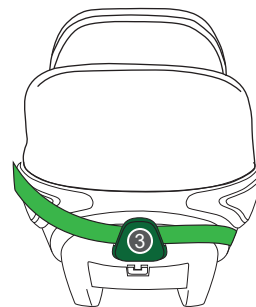

(27)

## Attach car seat to stroller

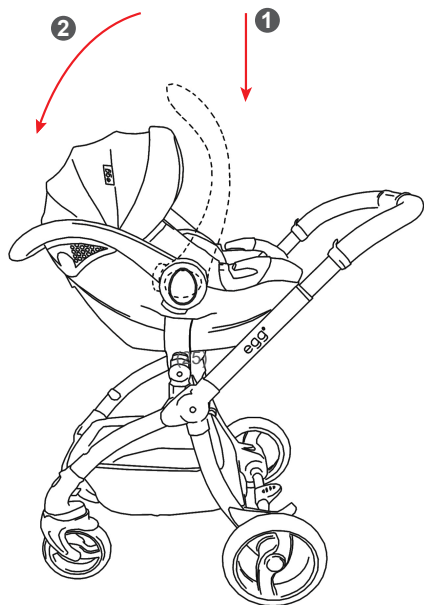

## Remove car seat from stroller

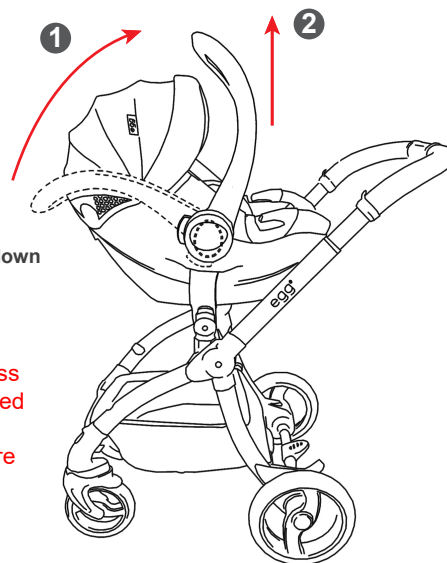

Locked; handle down

**WARNING:**  
Never use unless  
handle is in locked  
position, check  
car seat is secure  
before use

## **CRS (Child Restraint System / Infant Carrier / Car Seat) Features**

Refer to page 1&2

- 1, Handle
- 2, Handle button
- 3, Shoulder pad
- 4, Crotch pad
- 5, Buckle
- 6, Webbing-Harness belts
- 7, Press for harness extension
- 8, Pull to tighten harness
- 9a, Lap-belt guide (for belt installation)
- 9b, Diagonal belt guide
- 10, Canopy
- 11, Headrest
- 12, Inner pad
- 13, Car seat shell access door for shoulder harness adjustment and instruction manual compartment

## **Isofix Base for CRS (Child Restraint System / Infant Carrier / Car Seat)**

### **Features**

Refer to page 8

- 14, CRS connecting hook
- 15, ISOFIX connector anchor points
- 16, ISOFIX release button
- 17, ISOFIX rear leg extension lever
- 18, Release handle- CRS from ISOFIX base
- 19, ISOFIX Base cover
- 20, Indicator window; indicates correct installation of CRS on base when shows green
- 21, Indicator window to show ISOFIX locked, shows green when correctly fitted
- 22, Adjustment for support leg
- 23, Indicator window for support leg , shows green when correctly adjusted

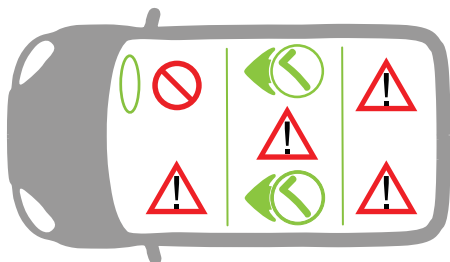
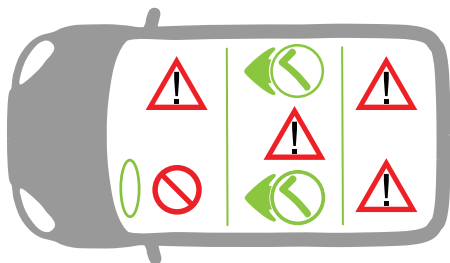

: Not to use this CRS in the seating positions where the frontal airbag is activated.

Seat covers/textile covers removal procedure for cleaning

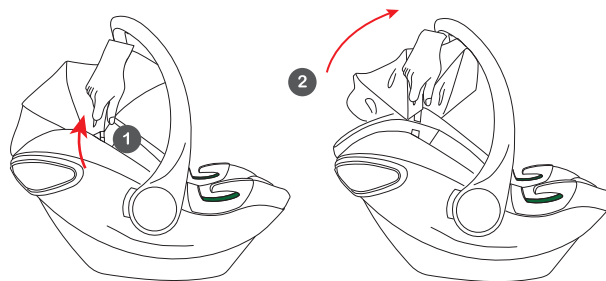

(30)

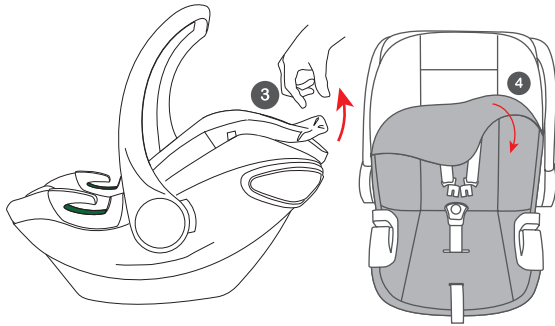

(31)

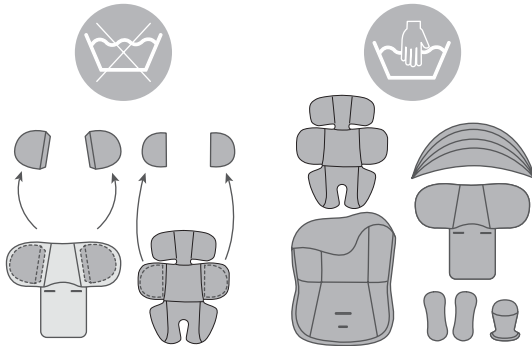

(32)

## IMPORTANT: KEEP FOR FUTURE REFERENCE

### Notice:

This is an "i-Size" Child Restraint System. It is approved to Regulation No.129, for use in, "i-Size compatible" vehicle seating positions as indicated by vehicle manufacturers in the vehicle users' manual.

If in doubt, consult either the child restraint manufacturer or the retailer.

This CRS is also suitable for use without an ISOFIX base when fitted in a compatible vehicle with a suitable car seatbelt, when used with the vehicles integral 3 point belt this CRS complies with ECE 44/04

**Warnings:** Any straps holding the restraint to the vehicle must be tight. Any support-leg must be in contact with the vehicle floor. Any straps restraining the child must be adjusted to the child's body, and that straps should not be twisted.

Any rigid items and/or plastic parts of a child restraint must be so located and installed that they are not liable, during everyday use of the vehicle, to become trapped by a movable seat or in a door of the vehicle. Do not use the car seat in seating positions where an active frontal airbag installed.

The car seat and or base must be changed if it is damaged or involved in a collision or accident.

## ALWAYS READ THE INSTRUCTIONS BEFORE USE

Do Not make any alterations or changes to the Egg Shell CRS as this could affect the performance of the car seat and render it unsafe.

Ensure the harness is fitted snugly, you should not be able to fit more than two fingers between the child and the harness belt.

Always follow closely the installation instructions provided by the child restraint manufacturer.

Never leave your child unattended

Any luggage or other objects liable to cause injuries in the event of a collision must be properly secured prior to travel.

This CRS shall not be used without the fabric cover;

The seat cover should not be replaced with any other than the one recommended by the manufacturer, the cover constitutes an integral part of the CRS performance.

The user should also refer to the vehicle manufacturer's handbook.

Check the CRS regularly, do not use if any part is broken torn or damaged.

The instruction manual should be kept in location as illustrated in the picture on page 2 or page 5, during the life time of the product.

It is dangerous to place the car seat on an elevated surface, e.g. a table or work top etc.

This car seat is not intended for prolonged periods of continuous use or sleeping, recommended max of 2 hours without a break, see point 15

Stop using this CRS after your baby reaches 13kg or is longer than 80cm.

Take your child out of the CRS as often as possible in order to relieve pressure on his/her spine.

The CRS is not suitable for sleeping for long periods of time, please use a suitable lie-flat bed instead.

Please contact your retailer or the manufacturer to replace or supplement any parts or components if they are missing or damaged.

### IMPORTANT: KEEP FOR FUTURE REFERENCE

**Handle Adjustment:** To adjust the carrying handle, simultaneously press the left and right buttons 1 (picture 3). You can lock the carrying handle in place in one of three positions A, B or C see picture 4.

A: Vehicle position in the car or carry position outside of the car.

B: Free standing rocking position or locked position when used on a stroller.

C: Stable position, non-rocking or the position to place the child into the CRS

**Adjusting the harness and placing the child in the CRS:** Loosen the shoulder belts (picture 4) by pressing the adjustment button (1) on the central adjuster and pulling both shoulder belts forwards (2)

Press the button under the rear central belt guide to open the manual compartment (picture 5). Lift up the lever (1) (picture 6) and simultaneously slide up and down to adjust the headrest and shoulder belts to the desired position. The harness shoulder belts should be adjusted to fit as shown in picture 7.

Separate the extended shoulder belts (picture 8) and place

the child in the CRS. Guide the harness belts directly over the child's shoulders and ensure they are not twisted. Place both buckle tongues together and lock them in place in the belt buckle, you should hear an audible 'CLICK' (picture 11). Pull carefully but firmly on the central adjustment to tighten the the harness until it fits the child's body (picture 12)

**Adjusting the canopy:** The canopy can be gradually extended forwards by pulling on the front cover. To fold; push back on the same front cover.

**Fitting the ISOFIX base into the vehicle:** Lift the lever (1) and simultaneously push forwards the top cover (2) of the supporting leg until it stops, this extends the rear legs (picture 15)

With the base sat on top of the vehicle seat; push the base back to connect the extended rear legs with the car ISOFIX anchor points. The indicator colour of the ISOFIX connector turns to green from orange when the legs are connected correctly (picture 16/17)

Push the whole ISOFIX base so that it touches the car seat backrest.

On the front support leg; push in the adjuster (1) as indicated by the arrow (picture 18) and lower the support leg until it firmly touches the floor of the vehicle. The colour of the indicator in the support leg should turn from orange to green when correctly fitted (picture 19).

**WARNING:** If there is any under-floor storage in the area where the support leg touches down; Do Not use the ISOFIX base in this position. Lower the carrier with the child harnessed-in, onto the base (picture 20), if the CRS is fitted correctly the indicator colour will change from orange to green (picture 21).

**ATTENTION:** The CRS should only ever face the back of the car when fitted.

**Removing the CRS from the ISOFIX base.** Pull the handle forwards (1), (picture 22) and lift the infant carrier/ car seat up and off the base (2) (picture 22)

### **Removing the ISOFIX base**

Lift up the lever (picture 23) and pull the whole base forwards to extend the ISOFIX legs.

Push back the orange buttons as indicated by the red arrow (a) (picture 24) to release the two ISOFIX connectors from the vehicle anchors, then pull the ISOFIX base away in the direction of the arrow (b) (picture 24).

## CRS Installation (Belted)

Installation in the car with car seatbelt :

Place the CRS facing the rear of the vehicle on the vehicle seat. **WARNING:** The CRS is not suitable for use with a two-point or lap seatbelt. Securing with a two-point seatbelt could result in serious or fatal injuries to the child in the event of an accident.

Pull out the vehicle seatbelt and route it over the CRS. Lock the buckle tongue in place in vehicle seatbelt (2) picture 25, the dark green belt section (pictures 25 and 26) show the lap belt position. Take the diagonal section of the seat belt shown in light green (Pictures 25,26 and 27) and route it around the back of the CRS and through the rear guide 3 (picture 25 and 27)

**Warning:** it may be that buckle part of the car seatbelt is too long so that it reaches the blue belt guides of the infant car seat. This means that the infant car seat cannot be fastened tightly. If this is the case, choose another seat in the car for the fitting of the CRS.

**ADVICE:** Seek fitting guidance from your local retailer who can offer expert advice.

## Care and Maintenance

Check the egg shell CRS regularly to make sure no parts are damaged/ torn/broken etc. This CRS is only safe for use if all parts are in good working order. Contact your retailer if you have concerns or require replacement parts

Avoid leaving the CRS in direct sunlight either in the vehicle or outside, even normal exposure to sunlight can cause the colour of the fabric to change, cover the CRS when left in direct sunlight. Plastic and metal parts can become hot as vehicles naturally experience very high temperature fluctuations , be aware and use caution on hot days.

## Cleaning

The cover and the belt can be sponge cleaned with lukewarm soapy water. The plastic parts can be cleaned with a mild detergent and warm water, do not use aggressive cleaning agents. Where individual items are provide with care labels follow the specific guidelines on the label.

## Your egg Warranty

At egg we pride ourselves in producing and delivering high quality products with our customers safety and wellbeing at the forefront of our minds.

## Date of effect.

The warranty of this product becomes valid from the date of purchase as stated on the original receipt of purchase. This does not affect your statutory rights.

## Registering your egg product

Thank you for purchasing an egg product. To activate your warranty and register you product visit [www.eggstroller.com](http://www.eggstroller.com) and click on

'Register your product' to complete the registration online.



## Your warranty policy

At egg, we guarantee your product has been manufactured in accordance with all current European safety standards which are applicable to this product, and that the product is free from defects in workmanship and material at the time of purchase. During the production process this product has gone through rigorous quality checks. Despite our efforts, if this product does show manufacturing or material defect within the 24 consecutive months warranty period we will comply with the warranty terms and conditions providing the product has been used for normal use as described within the instruction manual and it has been serviced and maintained correctly also described in the instruction manual. For further information please contact the place of purchase. Please retain your original receipt of purchase as it will be required should you need to use your warranty.

The warranty (24 consecutive months) only applies to the original purchaser and is non-transferable.

The warranty will be invalidated in the following circumstances:

- a, This product has not been used for its purpose other than described within the instruction manual.
- b, the product is returned for repair through a dealer which is not authorised by egg.
- c, if the defect is a result of improper use or incorrect maintenance, negligence or impact damage.
- d, If the original receipt of purchase cannot be provided.
- e, If the parts show normal wear that may be expected from regular use of the product.

For complete information about your egg product including: Registration, important updates and support; please visit the Product Information 'Support' section on ...

[eggstroller.com](http://eggstroller.com)

