

Installation TV screen on POS single display

BOX utilities

- TV screen
- Electricity cable
- Screws
- Drill bit
- White drill indicator plate



Step 1

Place white plate on right top corner of the POS display.



Step 2

Once white plate has been placed. Take a drill and implement the drill bit.



Step 3

Drill 4 holes which are indicated on the plate.



Step 4

Take the screen and place it to the front of the POS display, in line with the 4 drilled wholes.



Step 5

Take the 4 screws and a screwdriver and mount from the back the screen to the display in the 4 drilled wholes.



Step 6

Take the electricity cable of the screen. Plug the pin into the screen and the black holder into the plug holder.

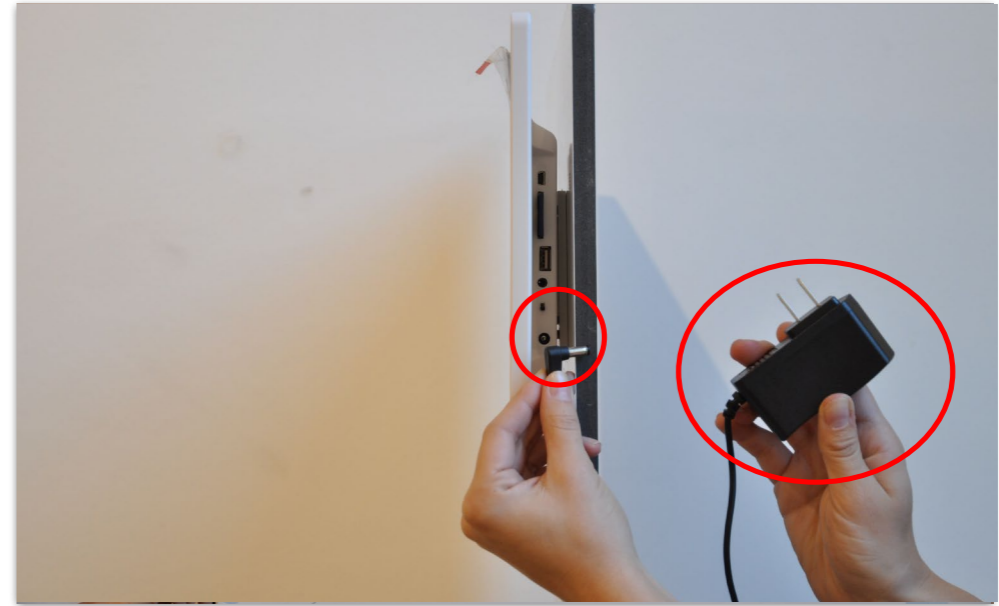

Step 7

Place the electricity cable along the POS display.



Step 8

Place the white plastics on top of the electricity cable to hide it alongside the POS display.



Step 9

Pull the protection plastics of the TV screen.

TV screen is mounted and ready for display.





Thanks.